



HBsAg, Anti-HBs, HBeAg/HBsAg

Hepatitis B is a widespread and serious liver disease. Hundreds of millions of people, most of them in regions with poor medical care, are chronically infected with the virus and face an elevated risk of acquiring liver cancer. The hepatitis B virus (HBV) is made up of an inner core surrounded by an outer capsule. The outer capsule contains the HBsAg (surface antigen). HBeAg is also found within the core. The detection of anti-HBs has become important in the follow up of patients with the Hepatitis B virus (HBV). It is also important when monitoring the recipients of vaccination with recombinant and natural anti-HBs.

General Information

SD BIOLINE Hepatitis tests are intended for professional use as an aid in the diagnosis of hepatitis B. highly sensitive, specific one step immunochromatographic assay for HBsAg, Anti-HBs, HBeAg/HBsAg.

	HBsAg	Anti-HBs	HBeAg/HBsAg
Specimen	Serum, Plasma, Whole blood	Serum, Plasma	Serum, Plasma
Detection Limit	2ng/ml	30mIU/ml	-
Sensitivity	>99%	91.7%	95.5%
Specificity	>99%	98.9%	98.6%

Materials Provided

- SD BIOLINE Test device /Multi-device /Strip

Test Procedure

- Add 100 µl of serum or plasma into the sample well.
- Interpret test results at 20 minutes.

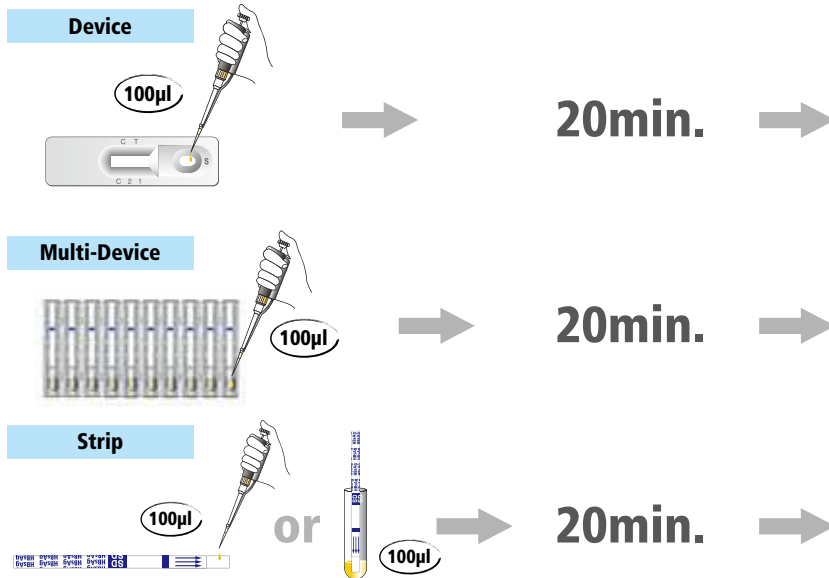

Interpretation

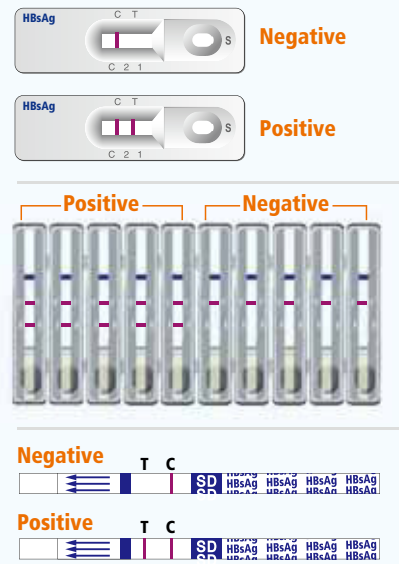

Ordering Information

Cat. No.	Description	Type	Pack size	Cat. No.	Description	Type	Pack size
01FK10	HBsAg	Device	1Tx30/Kit	01FK20	Anti-HBs	Device	1Tx30/Kit
01FK11	HBsAg	Multi-Device	10Tx10/Kit	01FK21	Anti-HBs	Multi-Device	10Tx10/Kit
01FK12	HBsAg Fast	Strip	25Tx4/Kit	01FK22	Anti-HBs Fast	Strip	25Tx4/Kit
01FK10W	HBsAg W/B	Device	1Tx30/Kit	01FK60	HBeAg/HBsAg	Device	1Tx30/Kit



The Hepatitis C virus (HCV) is recognized as a major agent of chronic hepatitis, transfusion acquired non-A, non-B hepatitis and liver disease throughout the world. HCV diagnostic kits detect the presence of HCV antibodies in human serum, plasma or whole blood by immunoassay. For diagnosis of HCV infection, recombinant proteins (Core, NS3, NS4 and NS5 protein) were used as capture materials and coated on the membrane of an immunochromatographic (rapid) test.

General Information

SD BIOLINE HCV test is a immunochromatographic rapid test for the qualitative detection of antibodies specific to HCV in human serum, plasma or whole blood.

- Recombinant HCV Core, NS3, NS4, NS5 Ag used as capture materials
- High Accuracy - Sensitivity : 100%, Specificity : 99.4%
- Specimen : Serum, Plasma, Whole blood

Materials Provided

- SD BIOLINE HCV test device / Multi-device / Strip
- Assay diluent

Test Procedure

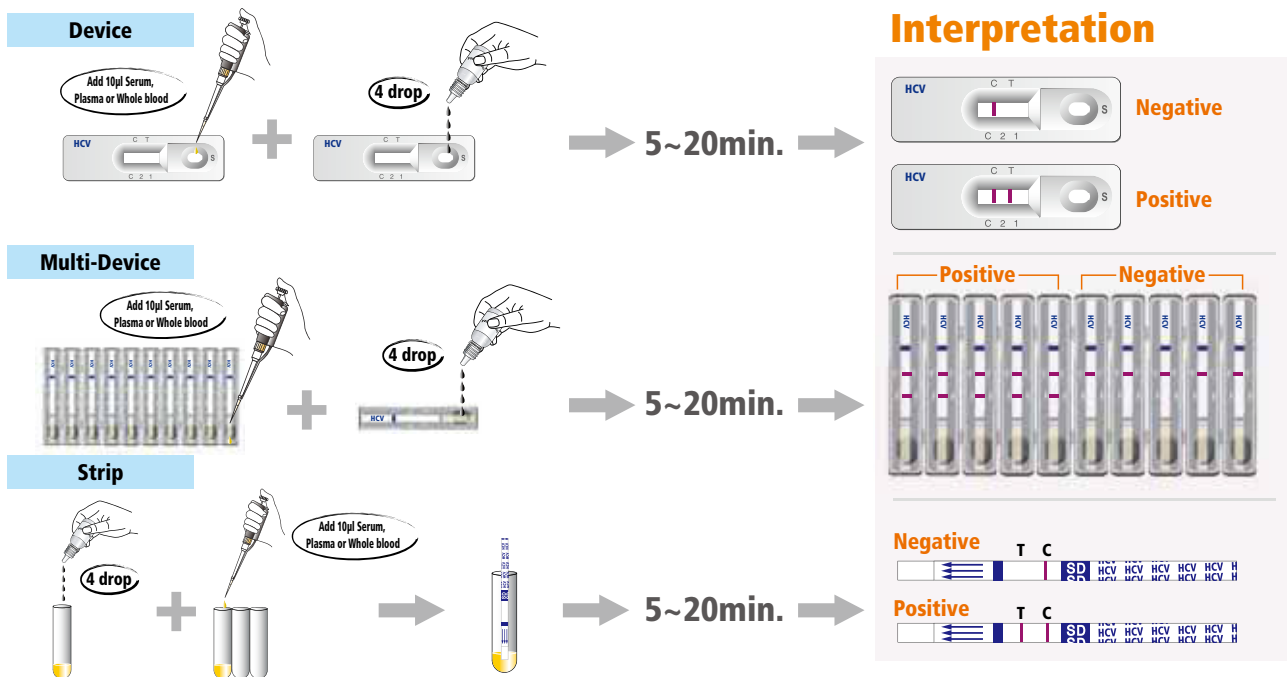

Ordering Information

Cat. No.	Description	Specimen	Type	Pack size
02FK10	HCV	Serum/Plasma	Device	1Tx30/Kit
02FK11	HCV	Serum/Plasma	Multi-Device	10Tx10/Kit
02FK12	HCV Fast	Serum/Plasma	Strip	25T/Kit
02FK10W	HCV W/B	Serum/Plasma/Whole blood	Device	1Tx30/Kit
02FK11W	HCV W/B	Serum/Plasma/Whole blood	Multi-Device	10Tx10/Kit

SD

BIO LINE

HIV-1/2 3.0



HIV (human immunodeficiency virus) is the virus that causes AIDS. This virus may be passed from one person to another when infected blood, semen or vaginal secretions come in contact with an uninfected person's broken skin or mucous membrane. In addition, infected pregnant women can pass HIV to their baby during pregnancy or delivery as well as through breast-feeding.

General Information

SD BIOLINE HIV-1/2 3.0 test is a immunochromatographic test for the differential and qualitative detection of all isotypes (IgG, IgM, IgA) antibodies specific to HIV-1 including subtype O and HIV-2 simultaneously, in human serum, plasma or whole blood.

- The 3rd Generation Method (Direct Sandwich Method, Ag-Ab-Ag)
- Serum, Plasma, Whole Blood specimen
- Highly sensitive even to IgM during early infection stage
- Differentiated test result between HIV type I and II by clear band formation (3-lines)
- Sensitivity : 100%, Specificity : 99.8%
- Capture Ag : HIV-1 (p24, gp41), HIV-2 (gp36)
- Evaluated by WHO (Sensitivity 100%, Specificity 99.3%)
- Procured by WHO, UNICEF, etc.
- Long shelf life : 24 months at room temperature

Relative performance in seroconversion panels as compared to the reference assay (Enzygnost HIV 1/2 plus)

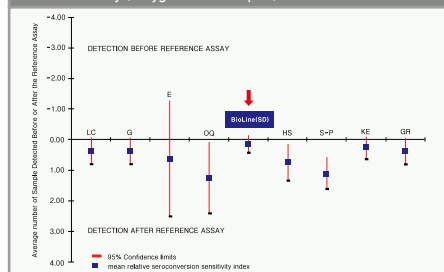

Materials Provided

- SD BIOLINE HIV-1/2 test device / Multi-device/ strip/ POCT
- Assay diluent
- Optional : Lancet, alcohol swab and capillary pipette (20µl / drop)

Test Procedure

I. Blood specimen (with a lancet)

- 1 Pierce with a sterile lancet provided.
- 2 Take a 20µl capillary pipette provided, draw blood into the capillary pipette to black line.
- 3 Add 20µl of drawn blood into the sample well (s).
- 4 Add 4 drops of assay diluent into the sample well (s).

II. Blood (by venipuncture), Plasma or Serum specimen

- 1 Add 10µl of plasma or serum (20µl of blood) into the sample well (s).
- 2 Add 4 drops of assay diluent into the sample well (s).

5~20min.

Interpretation

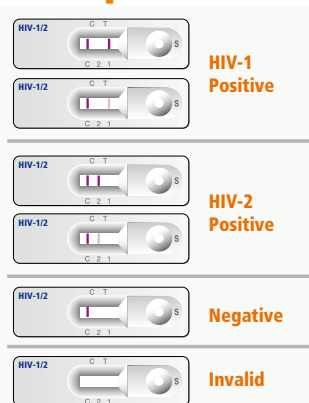

See the insert for detailed interpretation

Ordering Information

Cat. No.	Description	Specimen	Type	Pack size
03FK10	HIV 1/2 3.0	S/P/WB	Device	1Tx30/Kit
03FK10S	HIV 1/2 3.0	S/P	Device	1Tx30/Kit
03FK11	HIV 1/2 3.0	S/P	Multi-Device	10Tx10/Kit
03FK12	HIV 1/2 Fast	S/P	Strip	25T/Kit
03FK13	HIV 1/2 POCT	WB	POCT (*)	1T/Kit
03FK16	HIV 1/2 3.0	S/P/WB	Device (*)	1Tx25/Kit

(*) Lancet, Capillary pipette included.

SD BIO LINE Syphilis 3.0



Syphilis is a curable sexually transmitted disease caused by the *Treponema pallidum* spirochete. The route of transmission of syphilis is almost always by sexual contact. However, there are examples of congenital syphilis via transmission from mother to child in utero.

General Information

SD BIOLINE Syphilis 3.0 test is a solid phase immunochromatographic assay for the qualitative detection of antibodies of all isotypes (IgG, IgM, IgA) against *Treponema pallidum* (TP).

- One step qualitative immunochromatographic assay
- Specimen : Serum, Plasma, Whole Blood
- Evaluated by WHO with excellent performance
- Recombinant TP, 15kDa, 17kDa antigen used as captures and detectors
- The optimal choice for mass screening program
- No need preprocessing and equipment
- Room temperature storage

Performance Characteristics

Reference		SD BIOLINE Syphilis 3.0 test		Total Result
Method	Results	Positive	Negative	
TPHA Results	Positive	152	1	153
	Negative	1	209	210
Total Results		153	210	363

- Sensitivity : 99.3% (vs TPHA)
- Specificity : 99.55% (vs TPHA)

Materials Provided

- SD BIOLINE Syphilis 3.0 test device / Multi-device / Strip
- Assay diluent

Test Procedure

Device

5~20min.

Multi-Device

5~20min.

Strip

5~20min.

Interpretation

Negative

Positive

Negative T C

Positive T C

Ordering Information

Cat. No.	Description	Type	Specimen	Pack size
06FK10	Syphilis 3.0	Device	S/P/WB	1Tx30/Kit
06FK11	Syphilis 3.0	Multi-Device	S/P/WB	10Tx10/Kit
06FK12	Syphilis Fast 3.0	Strip	S/P	25T/Kit

SD

BIO LINE

Chlamydia



Chlamydia trachomatis is a bacterium which causes a sexually transmitted infection (STI). Chlamydia is very common disease, which should be taken very seriously. The most worrying effect of a chlamydial infection in women is that of potential fertility problems (PID, infertility, etc.), due to inflammation of the fallopian tubes or cervix. The disease is particularly common among young people.

General Information

SD BIOLINE Chlamydia test is a solid phase immunochromatographic assay for the rapid, qualitative detection of Chlamydia antigen directly from endocervical swab, cytology brush specimens.

- Antigen Detection : Therapeutic Drug Monitoring
- Easy to test : All materials provided, Ready to use reagent

Performance Characteristics (vs. culture)

	Sensitivity	Specificity
SD BIOLINE Chlamydia	93.1%	98.8%

Materials Provided

- SD BIOLINE Chlamydia test device
- Reagent A (Extraction solution)
- Reagent B (Neutralization solution)
- Sterile swabs and transport tubes
- Disposable droppers

Test Procedure

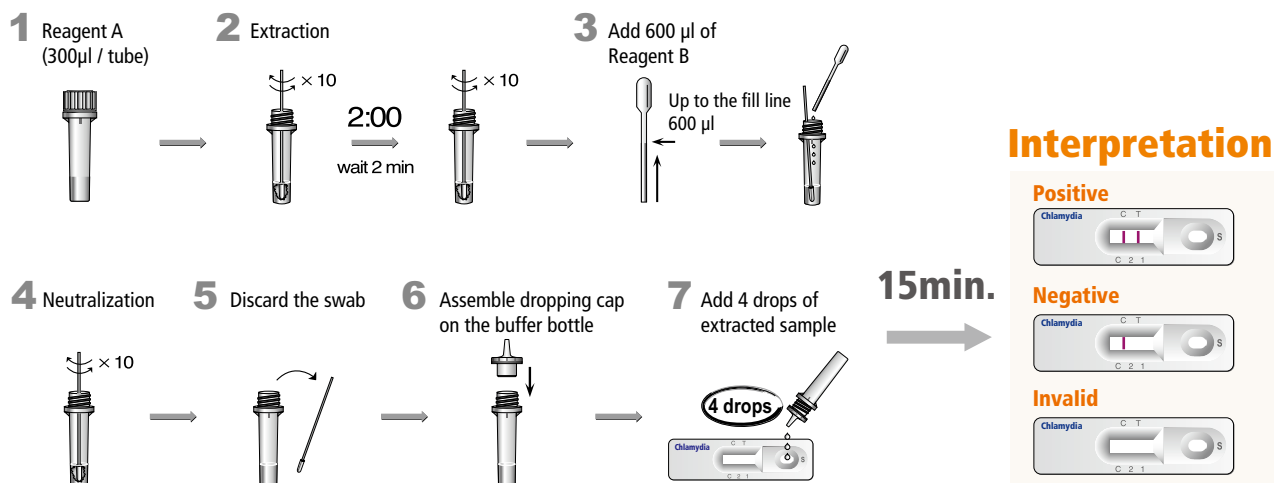

Ordering Information

Cat. No.	Description	Specimen	Type	Pack size
09FK10	Chlamydia	Endocervical swab, Cytology brush	Device	1Tx25/Kit

SD

BIO LINE

Malaria Ag



Malaria is a serious, sometimes fatal, parasitic disease characterized by high fevers, shaking chills and flu-like illness, and is caused by a parasite that is transmitted from one human to another by the bite of infected *Anopheles* mosquitoes. The disease now occurs in more than 90 countries worldwide, and it is estimated that there are over 500 million clinical cases and 2.7 million malaria-caused deaths per year, 75% of them are African children. The infection with *P. falciparum*, if not promptly treated, may be fatal.

General Information

SD BIOLINE Malaria Ag test is a rapid, qualitative test for the detecting of Plasmodium lactate dehydrogenase (pLDH), an enzyme produced both in the sexual and asexual forms of parasite.

- Differential diagnosis between *Plasmodium falciparum* and the other *Plasmodium* species (*P.vivax*, *P.ovale*, *P. malariae*)
- Specimen : Whole blood (5µl)
- Storage : Room temperature (1~30°C)
- Sensitivity : 96.8% (P.f), 95.5% (non-P.f)
- Specificity : 99.5%
- Useful to monitor the infection development after drug therapy

Materials Provided

- SD BIOLINE Malaria Ag test device
- Disposable sample applicator
- Assay diluent
- Option : Lancet, alcohol swab

Test Procedure

- 1 Clean the patient's finger. The alcohol MUST be dried before pricking, or test may not work.
- 2 Prick the patient's finger with the lancet to get blood.
- 3 1. With a 5µl capillary pipette, draw blood to black line.
2. Take a disposable specimen loop (5µl) provided, dip the circular end of a loop into the blood specimen.
- 4 1. Add 5µl of drawn blood into round sample well.
2. Add 5µl of drawn blood into round sample well touching sample pad.

* Use Loop : Let the circular end of the loop on the pad and press it slightly.
- 5 Add 4 drops of assay diluent into the square assay diluent well.
- 6 Interpret test results in 20~30 minutes.

20~30 mins

Caution : Don't read test results after 30 minutes. Reading too late can give false results.

Interpretation

Malaria P.f Positive

Malaria Pan Positive

Malaria Mixed Infection

Negative

Invalid

Ordering Information

Cat. No.	Description	Specimen	Type	Pack size
05FK40	Malaria Ag	Whole Blood	Device	1Tx25/Kit

SD

BIO LINE

Malaria Ag P.f Malaria Ag P.v



Malaria is a serious, sometimes fatal, parasitic disease characterized by high fevers, shaking chills and flu-like illness, and is caused by a parasite that is transmitted from one human to another by the bite of infected *Anopheles* mosquitoes. The disease now occurs in more than 90 countries worldwide, and it is estimated that there are over 500 million clinical cases and 2.7 million malaria-caused deaths per year, 75% of them are African children. The infection with *P. falciparum*, if not promptly treated, may be fatal.

General Information

Item	Malaria Ag P.f	Malaria Ag P.v
Detection	HRP-II (Histidine-Rich Protein II)	pLDH (Plasmodium Lactate Dehydrogenase)
Target species	<i>P. falciparum</i>	<i>P. vivax</i>
Sensitivity	99.7%	95.5%
Specificity	99.5%	99.5%

- Specimen : Whole blood (5µl)
- Test result : 20~30 minutes
- Storage : Room temperature (1~30°C)

Materials Provided

Item	Malaria Ag P.f	Malaria Ag P.v
Component	SD BIOLINE Malaria Ag P.f test device, Assay diluent, Disposable sample applicator	SD BIOLINE Malaria Ag P.v test device, Assay diluent, Disposable sample applicator
Option	Lancet, Alcohol swab	

Test Procedure

- Clean the patient's finger. The alcohol MUST be dried before pricking, or test may not work.
- Prick the patient's finger with the lancet to get blood.
1. With a 5µl capillary pipette, draw blood to black line.
2. Take a disposable specimen loop (5µl) provided, dip the circular end of a loop into the blood specimen.
1. Add 5µl of drawn blood into round sample well.
2. Add 5µl of drawn blood into round sample well touching sample pad.
- Add 4 drops of assay diluent into the square assay diluent well.
- Interpret test results in 20~30 minutes.

Caution :
Don't read test results after 30 minutes. Reading too late can give false results.

* Use Loop : Let the circular end of the loop on the pad and press it slightly.

Interpretation

Positive

Negative

Invalid

Ordering Information

Cat. No.	Description	Specimen	Type	Pack size
05FK50	Malaria Ag P.f	Whole Blood	Device	1Tx25/Kit
05FK70	Malaria Ag P.v	Whole Blood	Device	1Tx25/Kit

SD

BIO LINE

Malaria Ag P.f/Pan



Malaria is a serious, sometimes fatal, parasitic disease characterized by high fevers, shaking chills and flu-like illness, and is caused by a parasite that is transmitted from one human to another by the bite of infected *Anopheles* mosquitoes. The disease now occurs in more than 90 countries worldwide, and it is estimated that there are over 500 million clinical cases and 2.7 million malaria-caused deaths per year, 75% of them are African children. The infection with *P. falciparum*, if not promptly treated, may be fatal.

General Information

SD BIOLINE Malaria Ag P.f/Pan test is a one step, rapid, qualitative and differential test for the detection of HRP-II (Histidine-rich protein II) specific to *P. falciparum* and pLDH (*Plasmodium lactate dehydrogenase*) Pan specific to *P.* species in human blood sample.

- Differential diagnosis between *Plasmodium falciparum* and the other Plasmodium species (*P.vivax*, *P.ovale*, *P. malariae*)
- Specimen : Whole blood (5µl)
- Test result : 20~30 minutes
- Storage : Room temperature (1~30°C)
- Sensitivity : 99.7% (P.f), 95.5% (non-P.f)
- Specificity : 99.5%
- Maximized sensitivity and specificity

Materials Provided

- SD BIOLINE Malaria Ag P.f/Pan test device
- Assay diluent
- Disposable sample applicator
- Option : Lancet, alcohol swab

Test Procedure

- 1** Clean the patient's finger. The alcohol MUST be dried before pricking, or test may not work.
- 2** Prick the patient's finger with the lancet to get blood.
- 3** 1. With a 5µl capillary pipette, draw blood to black line.
2. Take a disposable specimen loop (5µl) provided, dip the circular end of a loop into the blood specimen.
- 4** 1. Add 5µl of drawn blood into round sample well.
2. Add 5µl of drawn blood into round sample well touching sample pad.
- 5** Add 4 drops of assay diluent into the square assay diluent well.
- 6** Interpret test results in 20~30 minutes.

*** Use Loop :** Let the circular end of the loop on the pad and press it slightly.

Caution : Don't read test results after 30 minutes. Reading too late can give false results.

Interpretation

Malaria P.f Positive

Malaria Pan Positive

Malaria Mixed Infection

Negative

Invalid

Ordering Information

Cat. No.	Description	Specimen	Type	Pack size
05FK60	Malaria Ag P.f/Pan	Whole Blood	Device	1Tx25/Kit

SD

BIO LINE

Malaria Antigen POCT



Malaria is a serious, sometimes fatal, parasitic disease characterized by high fevers, shaking chills and flu-like illness, and is caused by a parasite that is transmitted from one human to another by the bite of infected *Anopheles* mosquitoes. The disease now occurs in more than 90 countries worldwide, and it is estimated that there are over 500 million clinical cases and 2.7 million malaria-caused deaths per year, 75% of them are African children. The infection with *P. falciparum*, if not promptly treated, may be fatal.

General Information

SD BIOLINE Malaria Antigen POCT test is a qualitative test for the detecting of malaria antigen in human blood.

- Individual package including all materials
- Specimen : Whole blood (5µl)
- Test result : 20~30 minutes
- Storage : Room temperature (1~30°C)

Materials Provided

- SD BIOLINE Malaria Antigen POCT test device
- Disposable sample applicator
- Assay diluent
- Lancet, alcohol swab

Test Procedure

- 1** Clean the patient's finger.
The alcohol MUST be dried before pricking, or test may not work.

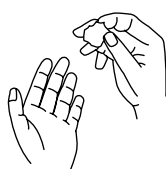

- 2** Prick the patient's finger with the lancet to get blood.

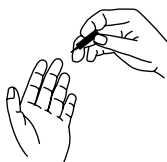

- 3** 1. With a 5µl capillary pipette, draw blood to black line.
2. Take a disposable specimen loop (5µl) provided, dip the circular end of a loop into the blood specimen

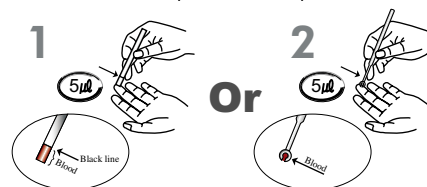

- 4** 1. Add 5µl of drawn blood into round sample well.
2. Add 5µl of drawn blood into round sample well touching sample pad.

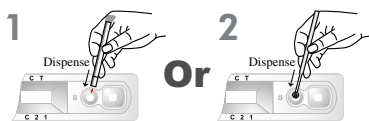

* Use Loop : Let the circular end of the loop on the pad and press it slightly.

- 5** Add 4 drops of assay diluent into the square assay diluent well.

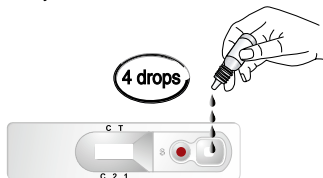

- 6** Interpret test results in 20~30 minutes.

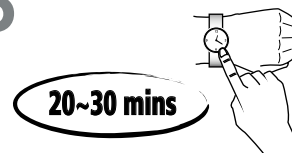

Caution :
Don't read test results after 30 minutes.
Reading too late can give false results.

Ordering Information

Cat. No.	Description	Specimen	Type	Pack size
05FK43	Malaria Ag POCT	Whole blood	Device	1T/Kit
05FK53	Malaria Ag P.f POCT	Whole blood	Device	1T/Kit
05FK63	Malaria Ag P.f/Pan POCT	Whole blood	Device	1T/Kit
05FK73	Malaria Ag P.v POCT	Whole blood	Device	1T/Kit

SD

BIO LINE

Malaria P.f/P.v



Malaria is a serious, sometimes fatal, parasitic disease characterized by high fevers, shaking chills and flu-like illness, and is caused by a parasite that is transmitted from one human to another by the bite of infected *Anopheles* mosquitoes. The disease now occurs in more than 90 countries worldwide, and it is estimated that there are over 500 million clinical cases and 2.7 million malaria-caused deaths per year, 75% of them are African children. The infection with *P. falciparum*, if not promptly treated, may be fatal.

General Information

SD BIOLINE Malaira P.f/P.v test is a qualitative immunochromatographic rapid test for detection of antibodies of all isotypes (IgG, IgM, IgA) specific to *Plasmodium falciparum* and *Plasmodium vivax* simultaneously in human serum, plasma or whole blood.

- Detecting all antibodies (IgG, IgM, IgA) against MSP of P.f and P.v
- Differentiated test results between *P. falciparum* and *P. vivax*
- Specimen : Serum, Plasma, Whole Blood

Performance Characteristics

		Malaria P.f	Malaria P.v
SD BIOLINE Malaria P.f/P.v test	Sensitivity	87%	86%
	Specificity	99.5%	

Materials Provided

- SD BIOLINE Malaria P.f/P.v test device
- Assay diluent

Test Procedure

- Add 10 µl of serum, plasma, or 20 µl of whole blood into the sample well.
- Add 3~4 drops of the assay diluent.
- Interpret test results in 5~20 minutes.

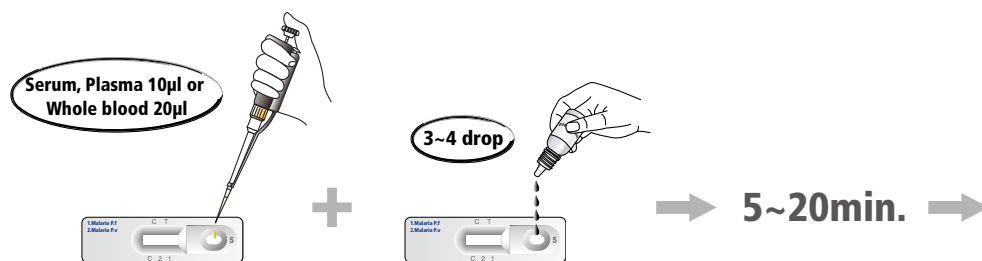

Interpretation

P.v Positive



P.f Positive

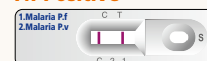

P.f/P.v Positive

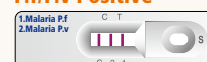

Negative



Ordering Information

Cat. No.	Description	Specimen	Type	Pack size
05FK30	Malaria P.f/P.v	S/P/WB	Device	1Tx30/Kit



Dengue viruses, transmitted by the mosquito, *Aedes aegypti* and *Aedes albopictus* mosquitoes, are widely distributed throughout the tropical and subtropical areas of the world. There are four known distinct serotypes (dengue virus 1, 2, 3 and 4). In children, infection is often subclinical or causes a self-limited febrile disease. However, if the patient is infected by a different serotype repeatedly, a more severe disease, dengue hemorrhagic fever or dengue shock syndrome, is more likely to occur. Dengue is considered to be the most important arthropod-borne viral disease due to the human morbidity and mortality it causes.

General Information

SD BIOLINE Dengue IgG/IgM test is a solid phase in vitro immunochromatographic test for the qualitative and differential detection of IgG and IgM antibodies to dengue virus serotype DEN-1, 2, 3 and 4.

- Differential detection of IgG and IgM antibodies
- Serum, Plasma, Whole Blood
- Test result : 3-lines(IgG, IgM, control)
- Highest accuracy in low titer specimen
- Presumptive differentiation between primary & secondary dengue infections
- Good correlation with Haemagglutination-Inhibition (HI) test
- No cross reactivity with other Flavivirus group mediated and mosquitoes-borne disease
- Sensitivity 94.6%, Specificity 94.1% (vs. HI test)

Materials Provided

- SD BIOLINE Dengue IgG/IgM test device, Assay diluent, Capillary pipette (5µl)
- SD BIOLINE Dengue IgG/IgM (WB) test device, Assay diluent, Capillary pipette (10µl)

Test Procedure

1. Dengue IgG/IgM



2. Dengue IgG/IgM WB



Interpretation

Positive

IgM Positive
(Primary dengue infection)

IgG Positive
(Secondary or past dengue infection)

IgG and IgM Positive
(Late primary or early secondary dengue infection)

Negative

Ordering Information

Cat. No.	Description	Specimen	Type	Pack size
11FK10	Dengue IgG/IgM	Serum, Plasma	Device	1Tx25/Kit
11FK20	Dengue IgG/IgM WB	Serum, Plasma, Whole blood	Device	1Tx25/Kit

SD

BIO LINE

Salmonella typhi IgG/IgM



Typhoid fever is a serious illness caused by a bacteria called Salmonella typhi. Symptoms of Salmonella typhi infection may be mild to severe and can include fever, headache, loss of appetite, constipation or diarrhea, and nonproductive cough. Typhoid fever is still common in developing countries and affects about 12.5 million persons each year. Salmonella typhi bacteria are shed in the urine or stool of infected persons, including chronic carriers. Typhoid fever is spread by eating or drinking contaminated food or water or by direct or indirect contact with fecal material from infected persons.

General Information

SD BIOLINE Salmonella typhi IgG/IgM rapid test is an immunochromatographic assay for the rapid, qualitative and differential detection of IgG and IgM antibodies to Salmonella typhi in human serum, plasma or whole blood.

This test provides only a preliminary test result. Therefore more specific alternative diagnosis method must be used in order to confirm salmonella typhi infection.

- IgM : Perfect alternative of Widal test
- IgG : Examination of past infection
- Specific screening test for Salmonella typhi
- Test result : 3-lines (IgG, IgM, Control)
- Specimen : Serum, Plasma or Whole blood
- Sensitivity : IgG-70% IgM-69% IgG+IgM-80%
- Specificity : IgG-76% IgM-79% IgG+IgM-81%
- Storage : Room temperature (2~30°C)

Materials Provided

- SD BIOLINE Salmonella typhi IgG/IgM Test Strip
- Assay diluent
- Disposable Loop (1µl)
- Disposable test tube

Test Procedure

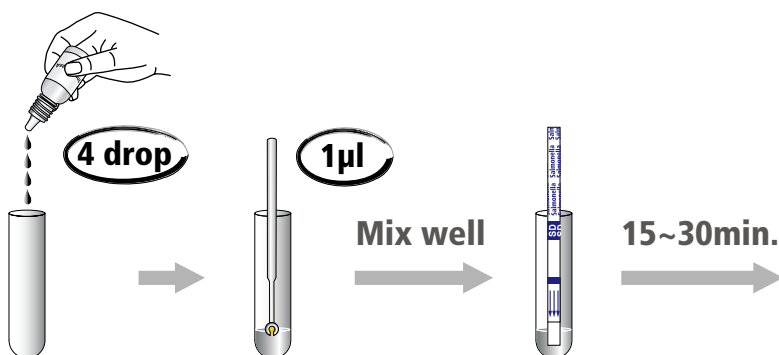

Interpretation

IgM Positive (acute typhoid fever)

G M C

SD Salmonella Salmonella Salin

IgG Positive (previous typhoid fever infection or re-infection)

G M C

SD Salmonella Salmonella Salin

IgG/IgM Positive (acute typhoid fever in the middle stage of infection)

G M C

SD Salmonella Salmonella Salin

Negative

G M C

SD Salmonella Salmonella Salin

Ordering Information

Cat. No.	Description	Specimen	Type	Pack size
15FK12	Salmonella typhi IgG/IgM	Serum/Plasma/Whole blood	Strip	1Tx25/Kit

SD

BIO LINE

Hantaan Virus Tsutsugamushi



Hantaan virus are carried by rodents and are spread to human via inhalation of aerosolized virus particles shed in the rodent feces and urine. Infection with Hantaan virus can range in severity from asymptomatic to a severe, life-threatening illness characterized by fever, hemorrhage, and renal failure.

O. tsutsugamushi, the causative agent of scrub typhus, is transmitted to human by the bite of a larval mite. The disease is characterized by fever, rash, eschar, pneumonitis, meningitis and disseminated intravascular coagulation which leads to severe multiorgan failure in untreated cases.

General Information

Item	SD BIOLINE Hantaan Virus	SD BIOLINE Tsutsugamushi
Disease	Hemorrhagic fever with renal syndrome (HFRS)	Scrub Typhus
Detection	Detection of IgG, IgM, IgA antibodies to genus Hantavirus like Hantaan virus, Seoul virus, Puumala virus, Prospect Hill virus	Detection IgG, IgM, IgA antibodies to Rickettsia Tsutsugamushi
Sample	Human serum, plasma or whole blood	Human serum, plasma or whole blood
Sensitivity	96%	99%
Specificity	94%	96%
Compared Method	IFA	IFA

Materials Provided

- SD BIOLINE Test device
- Assay diluent

Test Procedure

Device

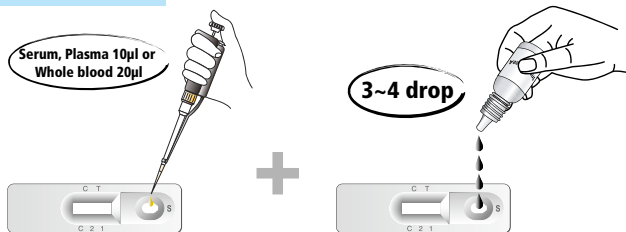

Hantaanvirus
15~20min.

Tsutsugamushi
10~15min.

Multi-Device

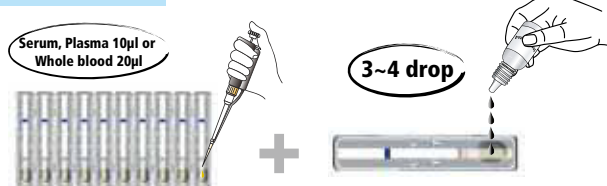

Hantaanvirus
15~20min.

Tsutsugamushi
10~15min.

Interpretation

Positive



Negative



Positive Negative



Ordering Information

Cat. No.	Description	Specimen	Type	Pack size
17FK10	Hantaan virus	S/P/WB	Device	1Tx30/Kit
17FK11	Hantaan virus	S/P/WB	Multi-Device	10Tx10/Kit
18FK10	Tsutsugamushi	S/P/WB	Device	1Tx30/Kit
18FK11	Tsutsugamushi	S/P/WB	Multi-Device	10Tx10/Kit

SD BIO LINE Leptospira



Eptospirosis occurs worldwide but is most common in temperate or tropical climates. It is an occupational hazard for many people who work outdoors or with animals, for example, farmers, sewer workers, veterinarians, fish workers, dairy farmers or military personnel. It is a recreational hazard for campers or those who participate in outdoor sports in contaminated areas and has been associated with swimming, wading, and whitewater rafting in contaminated lakes and rivers. The incidence is also increasing among urban children.

General Information

Item	Leptospira	Leptospira IgM	Leptospira IgG/IgM
Detection	Qualitative detection of IgG antibody to Leptospira interrogans	Qualitative detection of IgM antibody to Leptospira interrogans	Differential detection of IgG & IgM antibodies to Leptospira interrogans
Sample	10ul of serum or plasma or 20ul of whole blood	10ul of serum or plasma or 20ul of whole blood	5ul of serum or plasma
Interpreter	2 - Line (Control/Test)	2 - Line (Control/Test)	3 - Line (Control/IgG/IgM)

- Easy to use : no need of any instrument
- Test result: 20 minutes

Materials Provided

- SD BIOLINE Leptospira, Leptospira IgM, Leptospira IgG/IgM test device
- Assay diluent
- Capillary pipette (IgG/IgM)

Test Procedure

Leptospira / Leptospira IgM



Leptospira IgG/IgM

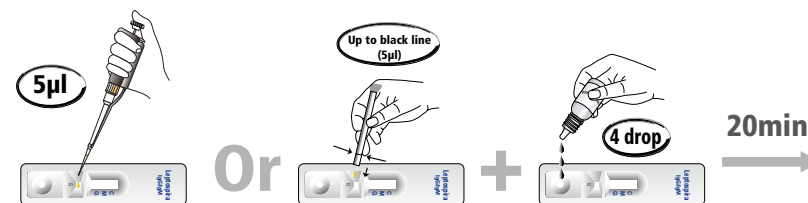

Interpretation

Leptospira / Leptospira IgM	Leptospira IgG/IgM
Positive 	IgG Positive
Negative 	IgM Positive
Invalid 	Negative
	Invalid

Ordering Information

Cat. No.	Description	Specimen	Type	Pack size
16FK10	Leptospira	S/P/WB	Device	1Tx30/Kit
16FK11	Leptospira	S/P/WB	Multi-Device	10Tx10/Kit
16FK30	Leptospira IgM	S/P/WB	Device	1Tx30/Kit
16FK40	Leptospira IgG/IgM	S/P/WB	Device	1Tx30/Kit

SD

BIO LINE

Influenza Ag Influenza H5



Influenza, commonly known as "flu", is a highly contagious viral infection of the respiratory tract. It affects both sexes and all age groups, but its highest incidence is in children. Outbreaks tend to occur in the winter and early spring when as many as 40% of children can become infected. There are three types of influenza viruses. Type A is usually responsible for the large influenza epidemics. Type A is constantly changing, with new strains appearing regularly. Influenza types A are divided into subtype H (hemagglutinin) and N (neuraminidase). The subtype H has H1~H15 types and the subtype N has N1~N9. Especially H1N1, H3N2, H2N2, H5N1 are important to a human infection.

General Information

Item	Influenza Antigen Test	Influenza H5 Test
Detection	Differential detection of Influenza virus type A & B	Detection of Influenza virus type A subtype H5
Sample	Human nasal swab, throat swab, nasopharyngeal swab or nasal/nasopharyngeal aspirate	Human nasal swab, throat swab, nasal/tracheal aspirate
Accuracy	Sensitivity (91.8%), Specificity 98.9% vs. Viral culture and RT-PCR as gold standard	Detecting all of H5N1 bird flu samples isolated from human in 2006, 2005, 2004 in Vietnam

Materials Provided

- SD BIOLINE Influenza Ag Test strip, Disposable tubes with rack, Assay diluent, Sterilized swab, Control swab, Disposable dropper
- SD BIOLINE Influenza H5 Test strip, Disposable tubes with rack, Assay diluent, Sterilized swab, Control swab, Disposable dropper

Test Procedure

Methods of Sample Collection

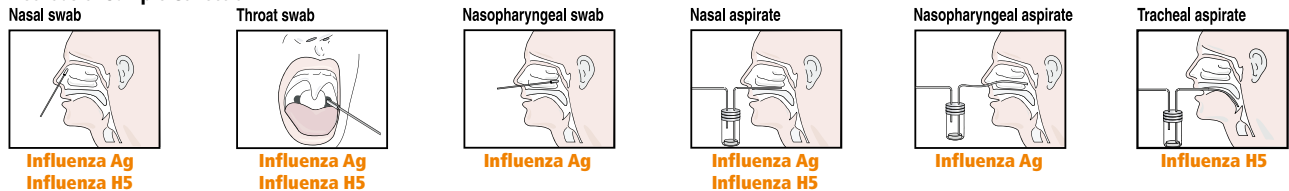

I. All swab Samples

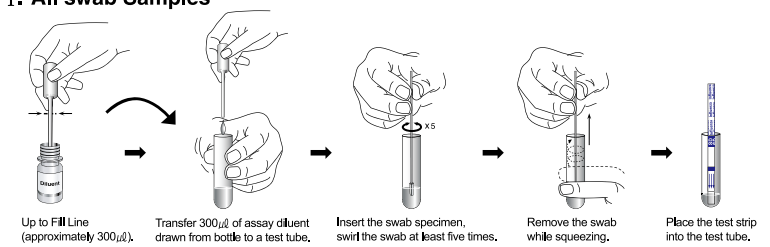

II. Nasal aspirate, nasopharyngeal aspirate specimen or Extracted specimen into transport media

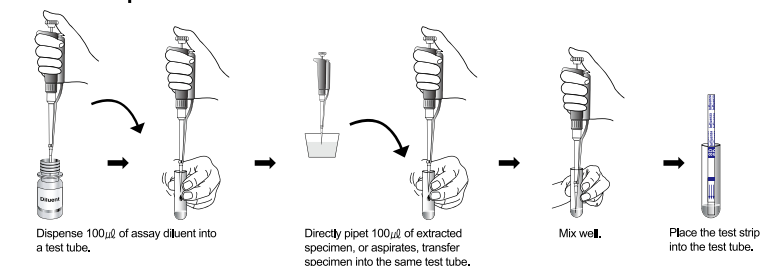

10~15min.

Interpretation

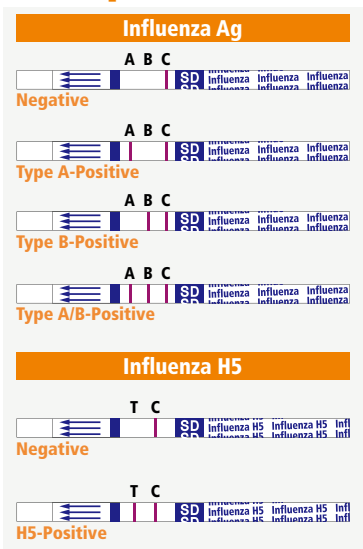

Ordering Information

Cat. No.	Description	Type	Pack size
19FK12	Influenza Virus A & B Antigen Test	Strip	1Tx25/Kit
19FK22	Influenza Virus H5 Antigen Test	Strip	1Tx25/Kit

SD

BIO LINE

RSV



RSV is the most common respiratory virus in infants and young children. It infects virtually all infants by the age of two. In most infants, the virus causes symptoms resembling those of the common cold. In infants born prematurely and/or with chronic lung disease, RSV can cause a severe or even life-threatening disease. Prior to the introduction of Synagis, RSV disease resulted each year in over 125,000 hospitalizations. There was a high mortality risk in approximately 2 percent of those infants.

General Information

SD BIOLINE RSV test is an immunochromatographic assay for qualitative detection of respiratory syncytial virus (RSV) in NPS (Nasopharyngeal secretion/ aspirations).

- Specimen: NPS (Nasopharyngeal secretion/ aspirations)
- Test result in 15minutes

Performance Characteristics (vs. culture)

	Sensitivity	Specificity
SD BIOLINE RSV	92.3%	93.3%

Materials Provided

- SD BIOLINE RSV test strip
- Disposable test tubes, droppers
- Extract buffer

Test Procedure

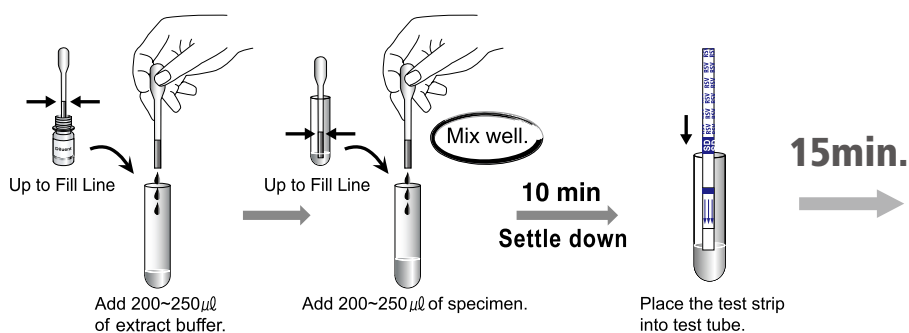

Interpretation

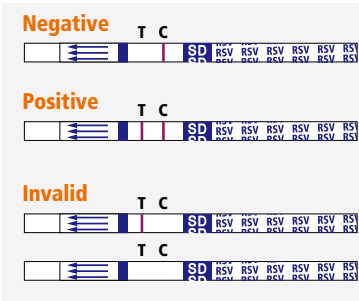

Ordering Information

Cat. No.	Description	Specimen	Type	Pack size
40FK12	RSV Test	NPS	Strip	1Tx25/Kit

SD

BIO LINE

Strep A



GAS (Group A streptococcus) is one of the most important causes of acute upper respiratory track infection. Hardly diagnosis and treatment of Group A Streptococcal pharyngitis has been shown to reduce the severity of symptoms and serious complications such as rheumatic fever and glomerulonephritis. Conventional identification procedures for GAS from throat swabs involve the isolation and subsequent identification of viable pathogen techniques that require 24–48 hours or longer for results.

General Information

SD BIOLINE Strep A rapid test is a chromatographic immunoassay for the qualitative detection of group A streptococcal antigens directly from throat swabs or confirmation of presumptive Group A Streptococcal colonies recovered from culture. The assay detects either viable or nonviable organisms directly form throat swabs or culture colonies within 5 ~ 10 minutes.

- Specimen : Throat swab
- Test result : 10 minutes

Performance Characteristics (vs. culture method)

	Sensitivity	Specificity
SD BIOLINE Strep A	87.3%	95.8%

Materials Provided

- SD BIOLINE Strep A test strip
- Extraction Reagent A, B
- Sterile throat swab
- Disposable test tube
- Positive / Negative control

Test Procedure

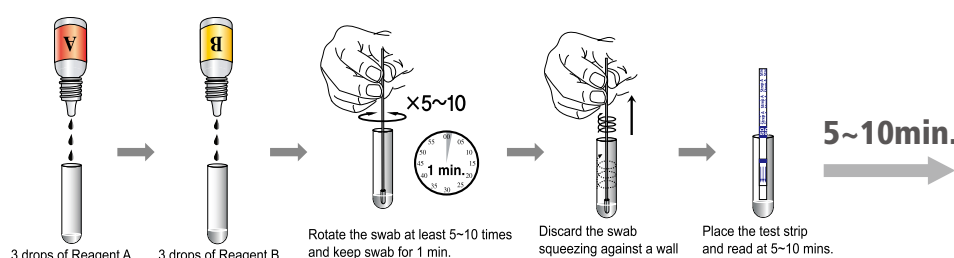

Interpretation

Negative T C

Positive T C

Invalid T C

Ordering Information

Cat. No.	Description	Specimen	Type	Pack size
45FK12	Strep A	Throat swab	Strip	1Tx25/Kit

SD

BIO LINE

TB TB W/B TB IgG/IgM



Tuberculosis (TB) is a disease caused by bacteria called *Mycobacterium tuberculosis*. The bacteria can attack any part of your body, but they usually attack the lungs. Morbidity of tuberculosis has been decreasing but recently HIV-associated tuberculosis and multi-drug resistant tuberculosis are on the rise. It's not easy to detect TB disease at the beginning of infection since there are few symptoms. Tuberculin skin test or chest X-ray can be used to screen TB. However, these methods require complex procedures or may not confirm that a person has TB disease. Serologic test can overcome these disadvantages with its simple and rapid method.

General Information

SD BIOLINE Rapid TB Test is an in vitro immunochromatographic test for the detection of antibodies to *Mycobacterium tuberculosis* in human serum, plasma or whole blood.

- Easy to test : No technician and equipment needed
- No cross reactivity with other species of *Mycobacterium*
- Good supplementary or substitutional test for X-ray screening or sputum culture examination

Item	TB	TB W/B	TB IgG/IgM
Detection	Simultaneous detection of all antibodies (IgG, IgM, IgA) to <i>M.tuberculosis</i>	Simultaneous detection of all antibodies (IgG, IgM, IgA) to <i>M.tuberculosis</i>	Differential detection of IgG and IgM (3-lines)
Sample	100µl of serum	10µl of serum or 20µl of whole blood	10µl of serum or plasma
Sensitivity	98.2%	96.4%	96.4%
Specificity	99.6%	98.2%	98.2%

Materials Provided

- SD BIOLINE TB test device
- SD BIOLINE TB IgG/IgM test device, Assay diluent
- SD BIOLINE TB WB test device, Assay diluent

Test Procedure

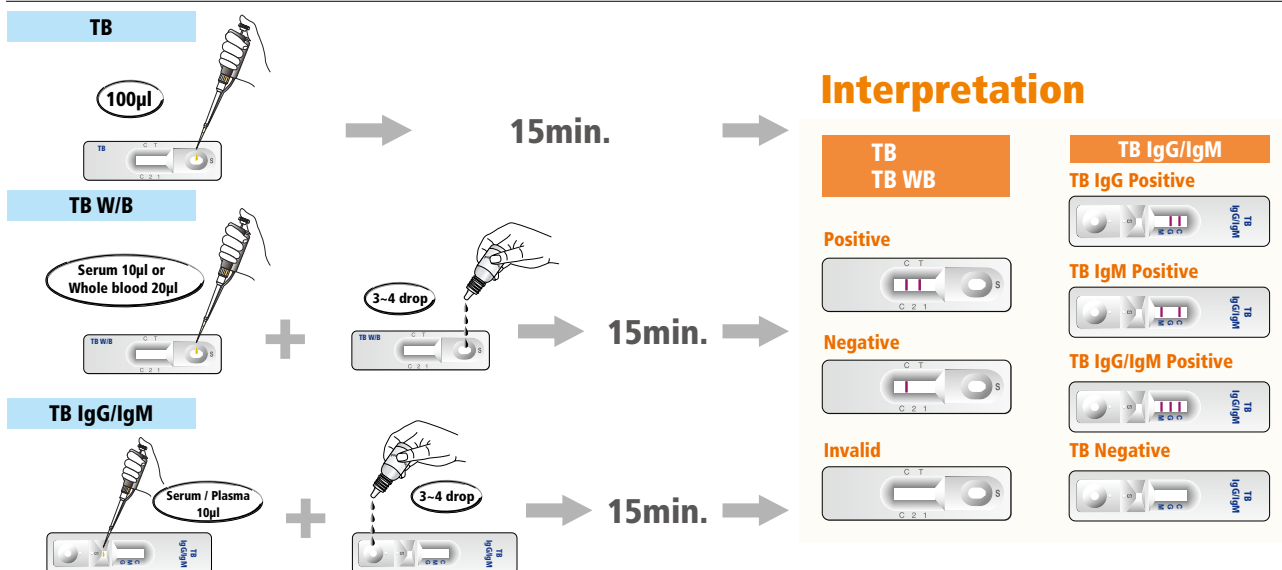

Ordering Information

Cat. No.	Description	Specimen	Type	Pack size
08FK10	TB	Serum	Device	1Tx30/Kit
08FK20	TB W/B	Serum/Whole blood	Device	1Tx30/Kit
08FK30	TB IgG/IgM	Serum/Plasma	Device	1Tx25/Kit

SD

BIO LINE

TB Ag MPT64



Tuberculosis is a highly infectious disease caused by *Mycobacterium tuberculosis* and potentially fatal disease of human. Biochemical, immunological and molecular biological characterization of *Mycobacterium tuberculosis* has led to the identification of several antigens which may be useful in the development of improved diagnostic methods in order to discriminate between the *M. tuberculosis* complex and mycobacteria other than *M. tuberculosis* (MOTT bacilli). *M. tuberculosis* has been known to secrete more than 33 different proteins. One of the predominant proteins, MPT64 was found in the culture fluid of only strains of the *M. tuberculosis* complex.

General Information

SD BIOLINE TB Ag MPT64 is a rapid immunochromatographic identification test for the *M. tuberculosis* complex.

- Simple, rapid assay using mouse monoclonal anti-MPT64
- Rapid discrimination between the *M. tuberculosis* complex and MOTT bacilli
- Identification of the *M. tuberculosis* complex in combination with culture systems based on liquid media
- Sample: Colony, Condensation fluid(Solid cultures) or Liquid cultures
- Test result: 15minutes

Materials Provided

- SD BIOLINE TB Ag MPT64 test device
- Extraction buffer (for sample preparation from solid cultures)

Test Procedure

Solid cultures

[Colony]

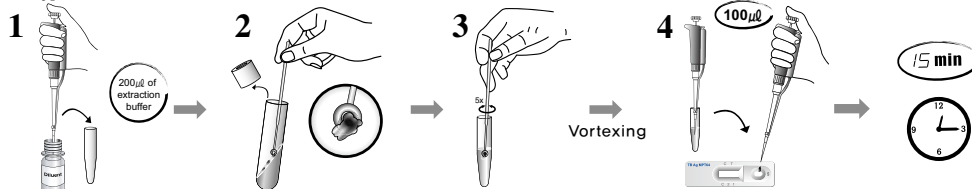

[Condensation fluid of slant agar tubes]

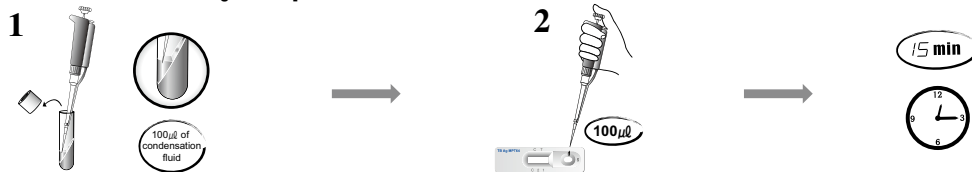

Liquid cultures

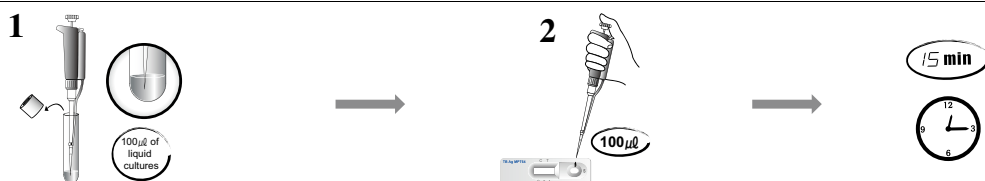

Interpretation

Positive



Negative



Invalid



Ordering Information

Cat. No.	Description	Specimen	Type	Pack size
08FK50	TB Ag MPT64	Liquid cultures / Solid cultures	Device	1Tx25/Kit

SD

BIO LINE

H.pylori



Helicobacter pylori (H. pylori) is a spiral-shaped bacterium and that is found in the gastric mucous layer or adherent to the epithelial lining of the stomach. H. pylori causes more than 90% of duodenal ulcers and up to 80% of gastric ulcers. Approximately two-thirds of the world's population is infected with H.pylori. The immunochromatographic techniques for the detection of antibodies specific to H. pylori has substantially resolved these problems.

General Information

SD BIOLINE H.pylori test is a rapid test for the qualitative detection of antibodies of all isotypes(IgG, IgM, IgA, etc.) specific to Helicobacter pylori in human serum, plasma or whole blood.

- Detection of all isotypes (IgG, IgM, IgA) antibodies against H.pylori
- High Accuracy - Sensitivity : 95.9%, Specificity : 89.6%
- Specimen : Serum, Plasma, Whole Blood

Materials Provided

- SD BIOLINE H. pylori test device/multi-device
- Assay diluent

Test Procedure

- Add 10 µl of serum/plasma or 20 µl of whole blood into the sample well.
- Add 3 drops of the assay diluent.
- Interpret test results at 10 minutes.

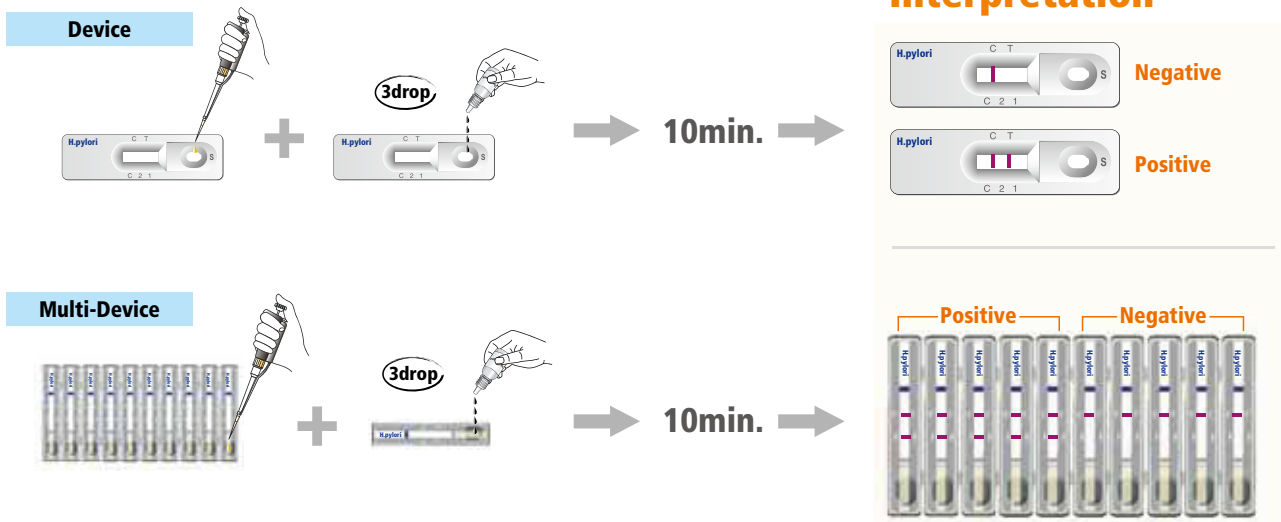

Ordering Information

Cat. No.	Description	Specimen	Type	Pack size
04FK10	H.pylori	S/P/WB	Device	1Tx30/Kit
04FK11	H.pylori	S/P	Multi-Device	10Tx10/Kit

SD

BIO LINE

H.pylori Ag



Helicobacter pylori (H. pylori) is a spiral-shaped bacterium that found in the gastric mucous layer or adherent to the epithelial lining of the stomach. H. pylori causes more than 90% of duodenal ulcers and up to 80% of gastric ulcers. Approximately two-thirds of the world's population is infected with H.pylori. The immunochromatographic techniques for the detection of antibodies specific to H. pylori has substantially resolved these problems.

General Information

SD BIOLINE H.pylori Ag test is a rapid immunochromatographic assay for the detection of Helicobacter pylori in human fecal specimens.

- Simple and easy to collect specimen : Non invasive test
- Sample: 50mg of stool
- Detection limit: 4ng/ml
- Test result: 10 minutes

Materials Provided

- SD BIOLINE H.pylori Ag test device
- Sample collection tube with assay diluent
- Sample collection swab
- Disposable dropper

Test Procedure

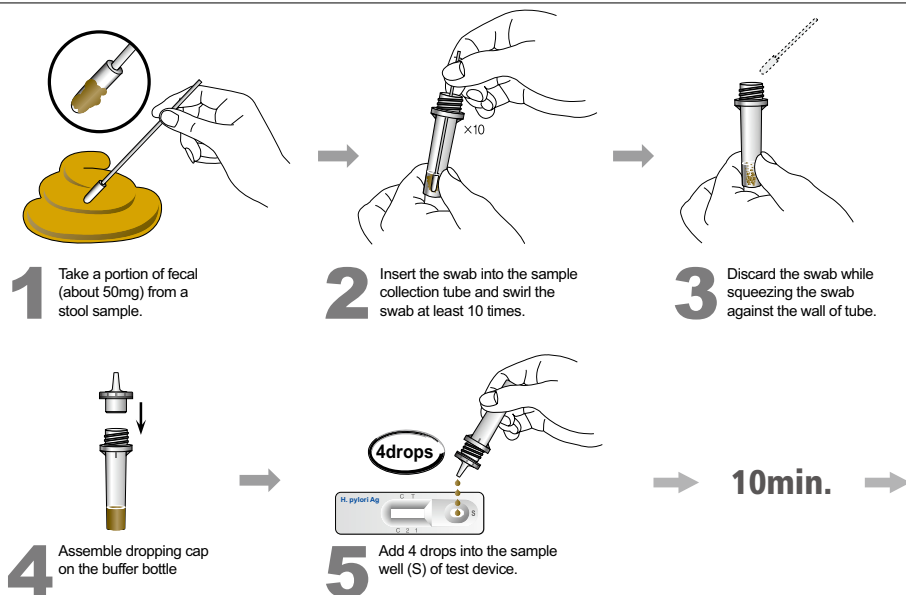

Interpretation

Negative



Positive

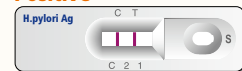

Invalid



Ordering Information

Cat. No.	Description	Specimen	Type	Pack size
04FK20	H.pylori Ag	fecal	Device	1Tx20/Kit



Rotavirus is the most common cause of severe, dehydrating diarrhea among children worldwide. Scientists have described seven rotavirus groups (A to G). Only groups A, B, and C infect humans. Group A, which has multiple strains, causes the majority of childhood infections. Although human of all ages are susceptible to rotavirus infection, children 3 to 24 months of age account for the vast majority of severe infections. A person with rotavirus diarrhea often excretes large amounts of virus, which can spread readily through contaminated hands. Rotavirus, a hearty virus that survives easily in the environment, can also be transmitted through contaminated objects, water or food.

General Information

SD BIOLINE Rotavirus test is an immunochromatographic assay for the detection of Group A rotavirus in fecal specimens. The test utilizes two kinds of antibody in a solid phase sandwich immunochromatography to detect group specific proteins, including the major inner capsid protein, present in Group A rotaviruses.

- Early detection of rotavirus antigen group A all serotype
- Convenient and clean test
- Specimen: Fecal specimens
- Sensitivity : 94%, Specificity 98.3% (vs. RT-PCR)
- Storage : Room temperature (1~30°C)

Materials Provided

- SD BIOLINE Rotavirus test device
- Sample collection tube with assay diluent
- Sample collection swab

Test Procedure

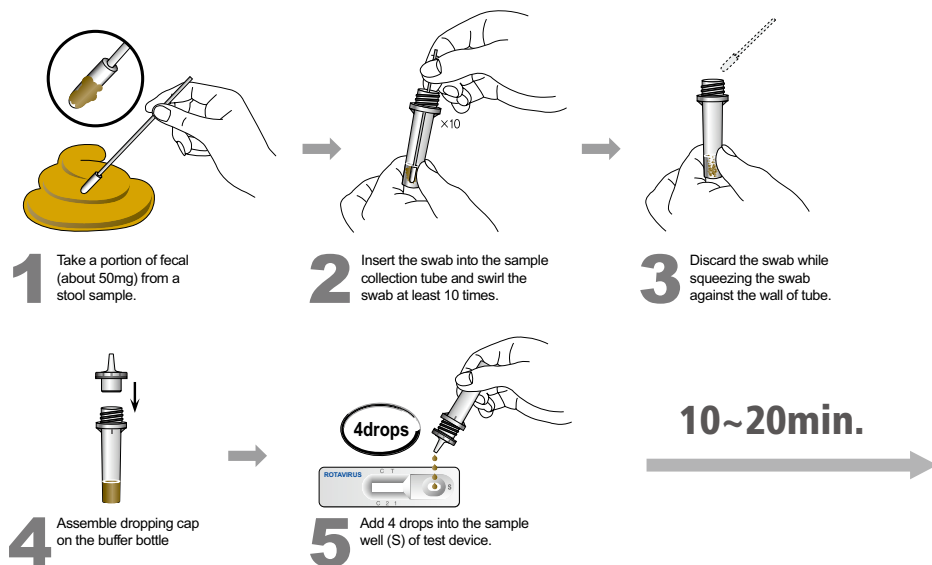

Interpretation

Positive



Negative



Invalid



Ordering Information

Cat. No.	Description	Specimen	Type	Pack size
14FK10	Rotavirus	fecal	Device	1Tx20/Kit

SD

BIO LINE

Rota/Adeno Ag



Rotaviruses are one of the major causes of pediatric gastroenteritis and diarrhea. Untreated rotavirus infection may result in severe illness with dehydration and disturbances of the body's normal electrolyte balance, especially in babies and preschool children.

Adenoviruses have been implicated in a wide range of clinical diseases affecting mainly the respiratory, ocular and the gastrointestinal systems of the human. Some adenovirus serotypes are enteric and have emerged as a major source of pediatric gastroenteritis.

General Information

SD BIOLINE Rota/Adeno Ag test is a rapid immunochromatographic assay for qualitative detection of the presence of rotavirus or adenovirus antigen in human fecal samples.

- Differentiation of test result by clear band formation(3-lines)
- Specimen : Fecal specimens
- Test result: 10 minutes

Materials Provided

- SD BIOLINE Rota/Adeno Ag test device
- Sample collection tube with assay diluent
- Sample collection swab

Test Procedure

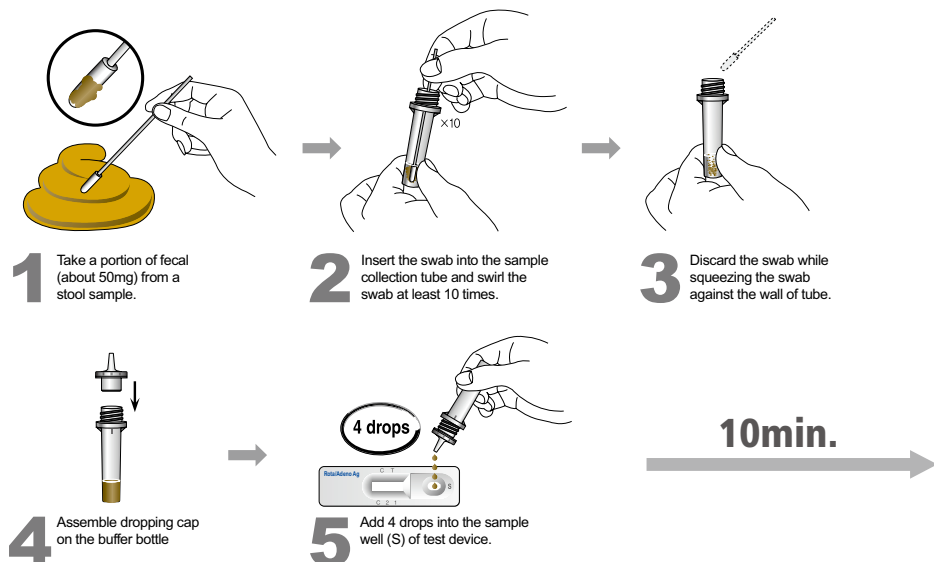

Interpretation

Adenovirus Positive



Rotavirus Positive

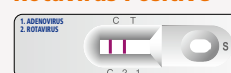

Negative



Ordering Information

Cat. No.	Description	Specimen	Type	Pack size
14FK20	Rota/Adeno virus	fecal	Device	1Tx20/Kit

SD

BIO LINE

Rubella IgG Rubella IgG/IgM



Rubella (commonly known as German measles or 3-day measles) is an infection that primarily affects the skin and lymph nodes. It is caused by the rubella virus (not the same virus that causes measles), which is usually transmitted by secretions from the nose or throat. It can also pass through a pregnant woman's bloodstream to infect her unborn child. As this is a generally mild disease in children, the primary medical danger of rubella is the infection of pregnant woman, which may cause congenital rubella syndrome in developing babies.

General Information

	Rubella IgG	Rubella IgG/IgM
Description	Semi-quantitative immunochromatographic assay	Differential immunochromatographic assay
Detection antibody	IgG	Rubella IgG and IgM
Test result	3 - Line C2 : Control line 2 (procedual) T : Test line C1 : Control line 1 (10 IU/ml)	3 - Line G : IgG result line M : IgM result line C : Control line
Cut off	10 IU/ml (compare with C1)	-
Sensitivity	>99.9%	IgG : 99.14% IgM : 98.33%
Specificity	>99.9%	IgG : 91.55% IgM : 97.64%
Use	Indicator of immune status	Indicator of immune status or confirmation of recent rubella infection

Materials Provided

- SD BIOLINE Rubella IgG/IgM test device, Assay diluent, Capillary pipette
- SD BIOLINE Rubella IgG test device, Assay diluent, Capillary pipette

Test Procedure

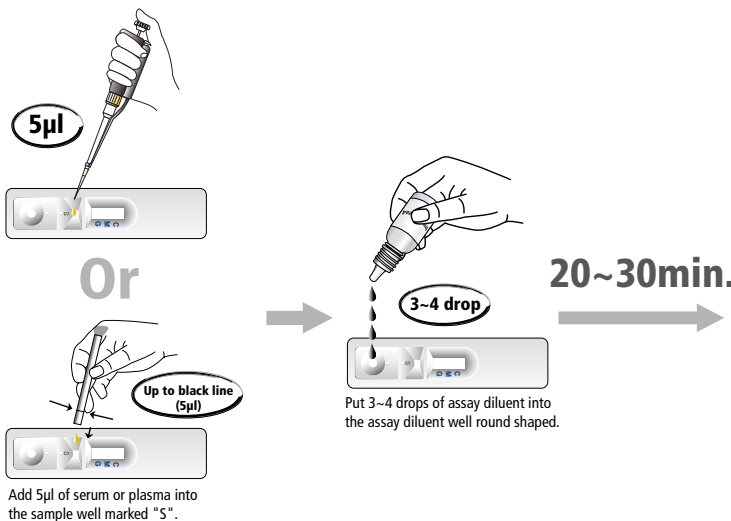

Interpretation

Rubell IgG	Rubell IgG/IgM
Rubella IgG Negative <ul style="list-style-type: none"> • Only control bands appeared (C1&C2) • T-C1 : weaker "T" than "C1" 	Rubella IgM Positive Rubella IgG Positive Rubella IgG/IgM Positive Rubella IgG/IgM Negative
Rubella IgG Positive <ul style="list-style-type: none"> • C1-T : Similar color and darkness of "C1" and "T" • C1-T : "T" may be darker than "C1" 	

Ordering Information

Cat. No.	Description	Specimen	Type	Pack size
07FK10	Rubella IgG	Serum/Plasma	Device	1Tx25/Kit
07FK20	Rubella IgG/IgM	Serum/Plasma	Device	1Tx25/Kit



Tetanus is an acute, often fatal, disease caused by a neurotoxin produced by *Clostridium tetani*. The toxin causes a high rate of disease outbreak and lethality by invading the nerve system. In case of infectious exposure from external injuries, an immunization with tetanus toxoid or its immunoglobulin is recommended to prevent tetanus from attacking. Also a sufficient titer level of tetanus antibody in blood is required to confirm even though a person has a tetanus immunization history in the infant and childhood, because the immunization may not be performed correctly or the antibody titer level declined by aging.

General Information

SD BIOLINE Tetanus test is one step, rapid immunochromatographic assay for qualitative detection of tetanus antibody in serum, plasma and whole blood.

- Specimen : Serum, Plasma and Whole blood
- Detection limit : 100 mIU/ml (serum, plasma), 200 mIU/ml (whole blood)
- Point of care test at emergency room
- Detection of tetanus antibody (IgG/IgM) before anti-tetanus toxoid immunoglobulin treatment
- Useful to determine tetanus antibody immune status :
Correctly protected - over 100mIU/ml (S/P), 200mIU (WB)
Slightly or not protected - below 100mIU/ml (S/P), 200mIU (WB)
- No interfering reactivity with hemoglobin, bilirubin or triglyceride
- Sensitivity 96.5%, specificity 87.0% (vs. ELISA)

Materials Provided

- SD BIOLINE Tetanus test device
- Assay diluent
- Capillary pipette

Test Procedure

Blood specimen

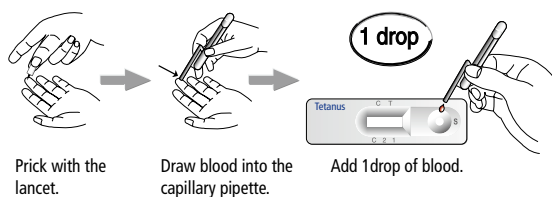

Blood (by venipuncture), plasma or serum specimen

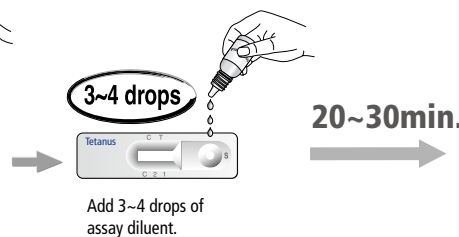
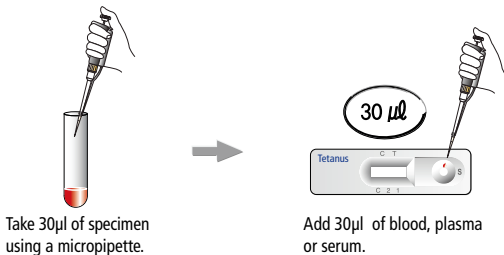

Interpretation

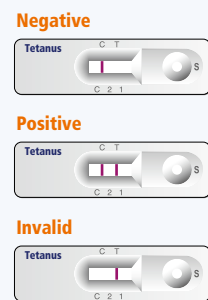

Ordering Information

Cat. No.	Description	Specimen	Type	Pack size
42FK10	Tetanus Test	S/P/WB	Device	1Tx25/Kit



SD

BIO LINE

AFP/CEA/PSA

Alpha-fetoprotein (AFP) is one of the most well-known carcinofetal antigens. Carcinoembryonic antigen (CEA) is a tumor-associated antigen, which is expressed largely in gastrointestinal track tumors. Prostate-specific antigen (PSA) is the most useful tumor marker in diagnosis of prostate cancers.

General Information

SD BIOLINE AFP, CEA, PSA tests are immunochromatographic assay designed for qualitative detection of AFP, CEA, PSA in human serum, plasma or whole blood.

Description	AFP	CEA	PSA
Detection	Alpha fetoprotein	Carcinoembryonic antigen	Prostate - specific antigen
Sample	Serum/Plasma/Whole blood	Serum/Plasma/Whole blood	Serum/Plasma/Whole blood
Cut - Off	20ng/ml	5ng/ml	3ng/ml
Sensitivity	100%	100%	98.6%
Specificity	100%	99.6%	98.9%

Materials Provided

- SD BIOLINE AFP, CEA, PSA test device / Multi-device
- SD BIOLINE AFP WB, CEA WB, PSA WB test device / Assay diluent

Test Procedure

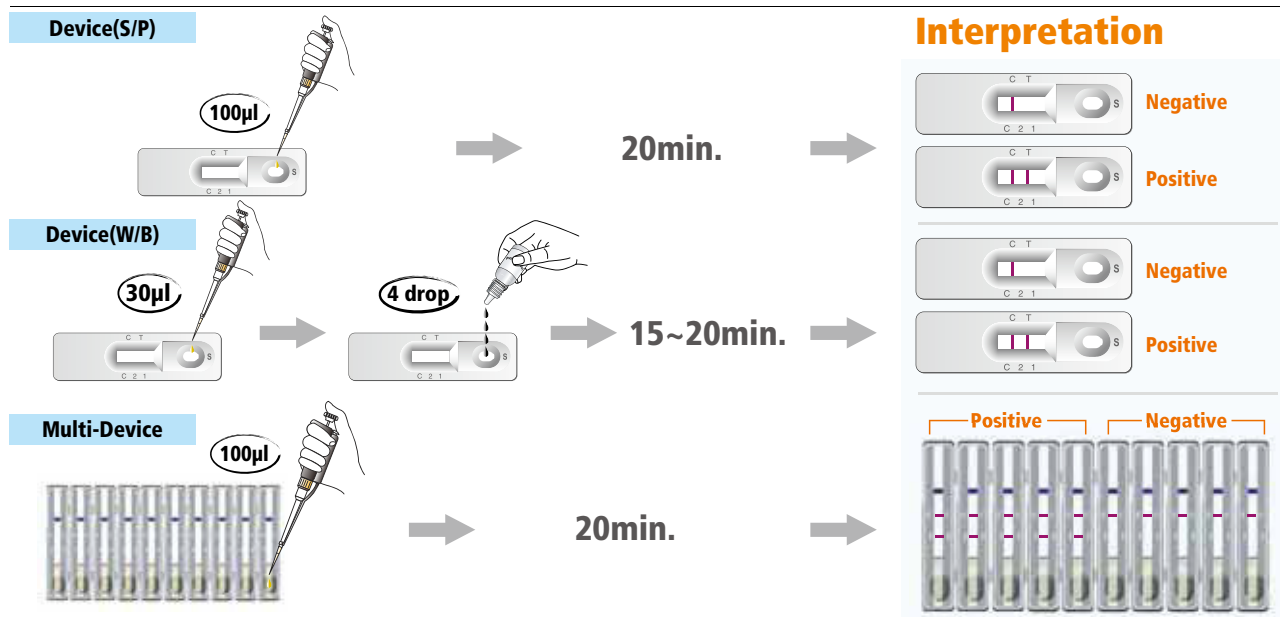

Ordering Information

Cat. No.	Description	Specimen	Type	Pack size
20FK10	AFP	S/P	Device	1Tx30/Kit
20FK11	AFP	S/P	Multi-Device	10Tx10/Kit
20FK14	AFP (W/B)	S/P/WB	Device	1Tx30/Kit
21FK10	CEA	S/P	Device	1Tx30/Kit
21FK11	CEA	S/P	Multi-Device	10Tx10/Kit
21FK20	CEA (W/B)	S/P/WB	Device	1Tx30/Kit
22FK10	PSA	S/P	Device	1Tx30/Kit
22FK11	PSA	S/P	Multi-Device	10Tx10/Kit
22FK20	PSA (W/B)	S/P/WB	Device	1Tx30/Kit



The detection of fecal occult blood is important for the diagnosis of disease that results in gastrointestinal bleeding and to screen for colorectal cancers and large adenomas that bleed. Screening for colorectal cancer probably increases the cancer detection at an early stage, therefore reduces the mortality.

General Information

SD BIOLINE FOB test is a rapid, qualitative test for the detection of human blood hemoglobin in human fecal specimens.

- Screening occult blood in fecal
- No cross reaction with animal blood
- Sensitivity : 98%, Specificity : 98.5%
- Specimen : Fecal
- Detection Limit : 50 ng/ml of human blood hemoglobin
- Test result in 5~10 minutes

Materials Provided

- SD BIOLINE FOB test multi-device
- Sample collection tube with assay diluent
- Storage and transport bag for specimen container

Test Procedure

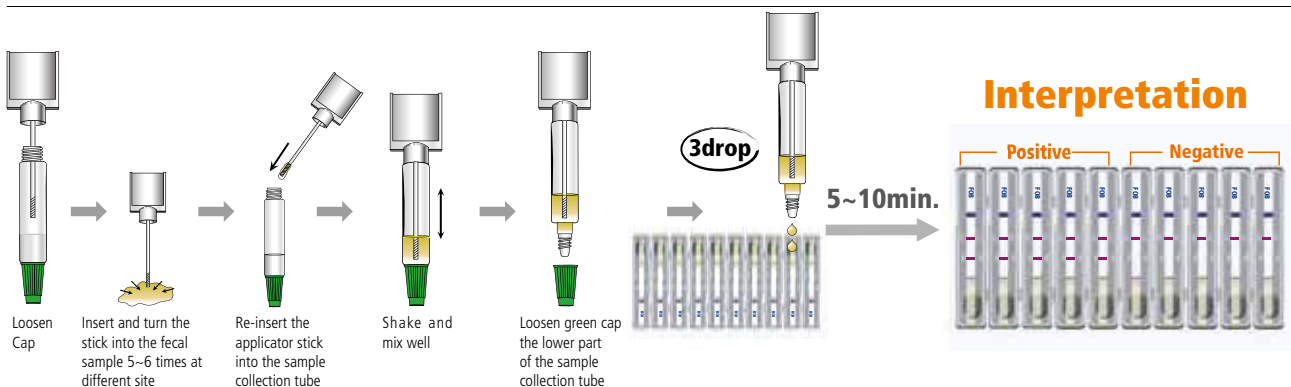

Ordering Information

Cat. No.	Description	Specimen	Type	Pack size
25FK12	FOB(Fecal Occult Blood)	Fecal	Multi-Device	10Tx5/Kit

SD BIO LINE hCG



Human chorionic gonadotropin (hCG) is a glycoprotein hormone secreted by the developing placenta shortly after fertilization. When you are pregnant, your body will produce special pregnancy hormone known as hCG.

General Information

SD BIOLINE hCG test is an immunochromatographic assay designed for qualitative detection of hCG in urine.

- Test result: urine 3minutes / serum 5minutes
- Detection : 25 mIU/ml
- Specimen : Urine, Serum
- Cross reactivity : No cross reactivity with 200 mIU/ml of hLH, 1,000 mIU/ml of hFSH and 1,000µIU/ml of hTSH

Test Procedure

Device

Midstream

Strip

Interpretation

Non-Pregnancy

Pregnancy

Non-Pregnancy

Pregnancy

Non-Pregnancy

Pregnancy

Ordering Information

Cat. No.	Description	Type	Pack size
30FK10	hCG (Urine)	Device	1Tx25/Kit
30FK11	hCG (Urine)	Midstream	1T/Kit
30FK12	hCG (Urine)	Strip	25Tx4/Kit
30FK15	hCG (Urine)	Strip	1Tx25/Kit
30FK20	hCG (Urine, Serum)	Device	1Tx25/Kit
30FK22	hCG (Urine, Serum)	Strip	25Tx4/Kit

SD

BIO LINE

LH / FSH



Human luteinizing hormone (hLH) is a glycoprotein hormone secreted by the anterior pituitary. Detection of the hLH surge can aid in predicting the time of ovulation. Human follicle stimulating hormone (hFSH) is a glycoprotein hormone secreted by the basophilic cell of the anterior pituitary under the control of other hormone.

General Information

SD BIOLINE LH, FSH tests are immunochromatographic assay designed for qualitative detection of LH, FSH in urine.

- Test results in 5~10 minutes

	LH	FSH
Specimen	Urine	Urine
Cross reactivity	No cross reactivity with hFSH, TSH, hCG	No cross reactivity with hCG, LH, TSH

Test Procedure

Device (LH)

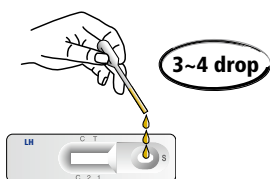

10min.

Interpretation

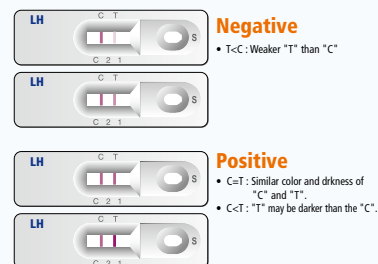

Midstream (LH, FSH)



Or



5min.

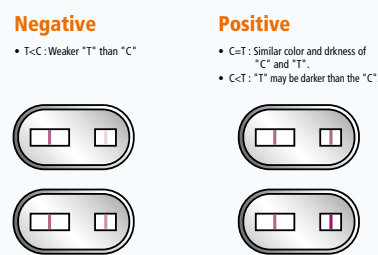

Ordering Information

Cat. No.	Description	Type	Pack size
31FK10	LH (Urine)	Device	1Tx25/Kit
31FK12	LH (Urine)	Midstream	1T/Kit
32FK11	FSH (Urine)	Midstream	1T/Kit



Drug abuse has a wide range of definitions related to taking a psychoactive drug or performance enhancing drug for a non-therapeutic or non-medical effect. Depending on the actual compound, drug abuse may lead to health problems, social problems, physical dependence, or psychological addiction.

General Information

SD BIOLINE DOA test is a rapid, one step, immunochromatographic assay designed for qualitative detection of drug metabolite in human urine at a cut-off concentration.

- Established as a guideline by U.S. NIDA
- No instruments needed

Item	MET	THC	MOP	COC	AMP	MDMA
Cut-off	1000ng/ml	50ng/ml	300ng/ml	300ng/ml	1000ng/ml	500ng/ml
Sensitivity	99.5%	99.4%	99.4%	99.4%	99.5%	100%
Specificity	>99%	>99%	>99%	>99%	>99%	>95.2%

- DOA Multi-10

Product Name	Target compound	Cut-off levels (ng/ml)	Product Name	Target compound	Cut-off levels (ng/ml)
THC (marijuana)	11-nor- Δ^9 -THC-9-COOH	50	MDN	Methadone	300
MOP	Morphine	300	BZO	Oxazepam	300
COC (cocaine)	Benzoylcegonine	300	BAR (barbituates)	Secobarbital	1000
AMP	D-Amphetamine	1000	TCA (tricyclic antidepressants)	Nortriptyline	1000
MET	D-Methamphetamine	1000	PCP	Phencyclidine	25

Materials Provided

- SD BIOLINE DOA test device / Multi-device / Strip
- Disposable urine dropper

Test Procedure

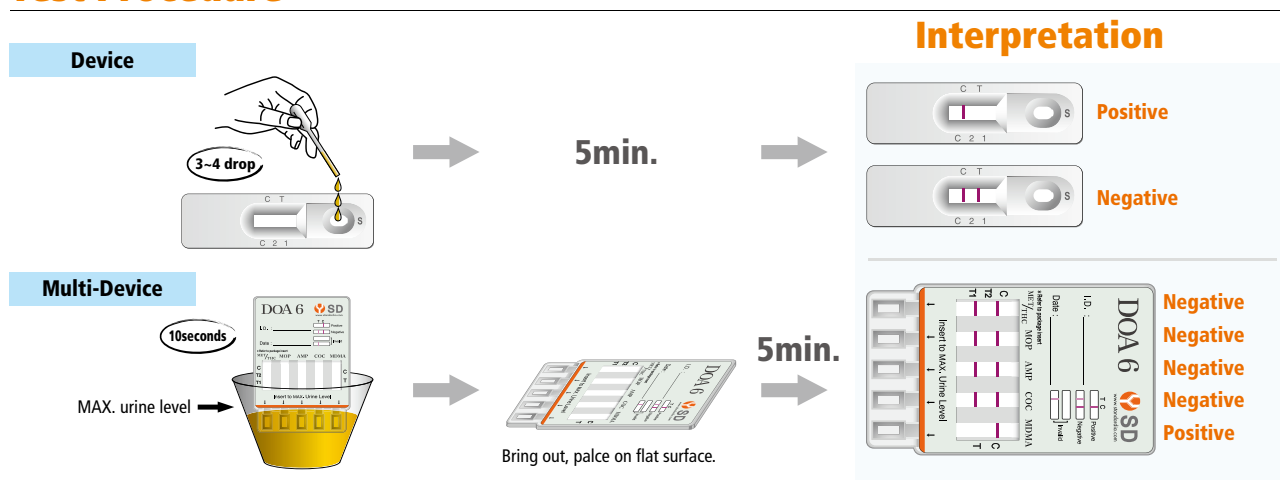

Ordering Information

Cat. No.	Description	Type	Pack size	Cat. No.	Description	Type	Pack size
50FK10	MOP	Device	1Tx25/Kit	50FK60	MET/THC	Device	1Tx25/Kit
50FK20	MET	Device	1Tx25/Kit	50FK100	MDMA	Device	1Tx25/Kit
50FK30	AMP	Device	1Tx25/Kit	50FK80	DOA Multi-3	Device	1Tx25/Kit
50FK40	COC	Device	1Tx25/Kit	50FK150	DOA Multi-5	Multi-Device	1Tx10/Kit
50FK50	THC	Device	1Tx25/Kit	50FK130	DOA Multi-6	Multi-Device	1Tx10/Kit
50FK53	THC	Strip	1Tx25/Kit	50FK210	DOA Multi-10	Multi-Device	1Tx10/Kit



BIO LINE

Nicotine Test Diet Check Quick Mite Test Guanine Test



General Information

	Nicotine	Diet Check	Quick Mite Test	Guanine Test
Discription	One Step Cotinine Test (Nicotine metabolite)	One Step Test to check body fat breakdown	Easy One Step Test to detect house dust mite	Simple Test to detect guanine
Specimen	Urine	Urine	Dust in sofa, mattress, bed, carpet, etc.	Dust in sofa, mattress, bed, carpet, etc.
Materials provided	Test device Disposable dropper	Test Strip	Test device Assay diluent Disposable swab	Test strip Assay diluent

Test Procedure

Nicotine Test

Quick Mite Test

Diet Check

Interpretation

	Color change	Concentration	Interpretation
	White	Less 30 mg/dl	No body fat breakdown
	Very faint pink	3-8 mg/dl	Body fat down on the way
	Faint pink	8-20 mg/dl	Moderate of body fat down
	Dark pink	20-40 mg/dl	Excess body fat down
	Purple	Over 40 mg/dl	Extreme body fat down (Requiring professional advice)

Ordering Information

Cat. No.	Description	Type	Pack size
60FK50	Nicotine Test	Device	1Tx10/Kit
60FK20	Diet Check	Strip	25T/Kit
60FK10	Quick Mite Test	Device	1Tx2/Kit
60FK30	Guanine Test	Strip	100T/Kit

SD

BIO LINE

Bio-Defense Pathogens and Toxins



Bio-Defense pathogens and toxins test is a chromatographic immunoassay for the qualitative detection of 10 kinds of biological weapons such as anthrax spores, *C. botulinum* toxin A (*Clostridium botulinum* toxin A), *Brucella* spp. (*B. abortus*, *mellitensis*, *suis*), Poxvirus, Ricin (*Ricinus Communis* L.), SEB (*Staphylococcus aureus* enterotoxin type B), *F. tularensis* (*Francesilla tularensis*), *Y. pestis* (*Yersinia pestis*), *V. cholerae* O1 & O139 (*Vibrio cholerae* O1 & O139), *Salmonella typhi* in environmental specimens.

General Information

- Designed to detect suspected Bio-Defense pathogens and toxins in environmental samples in 20 minutes.
- Developed by working with KCDC (Korean Center for Disease Control and Prevention).

Cat. No.	Item	Type	Pack size	Characteristics	Acceptance Criteria
1	Anthrax spore	Device	1Tx10/Kit	Detection of <i>Bacillus anthracis</i> spore antigen No cross reaction with other <i>Bacillus</i> spp.	10 ⁵ CFU/ml
2	Botulinum toxin	Device	1Tx10/Kit	Detection of <i>Clostridium botulinum</i> toxin A, antigen No cross reactivity with other <i>Clostridium</i> spp.	50ng/ml
3	Ricin	Device	1Tx10/Kit	Detection of Ricin from Cator bean (<i>Ricinus communis</i>) antigen	50ng/ml
4	SEB	Device	1Tx10/Kit	Detection of <i>Staphylococcus aureus</i> enterotoxin B antigen	10ng/ml
5	Tularemia	Device	1Tx10/Kit	Detection of <i>Francesilla tularensis</i> LPS antigen	10 ⁵ CFU/ml
6	Y. Pestis	Device	1Tx10/Kit	Detection of <i>Yersinia pestis</i> F1 antigen No cross reactivity with other <i>Yersinia</i> spp.	10 ⁵ CFU/ml
7	Poxvirus	Device	1Tx10/Kit	Detection of Poxvirus (<i>Variola virus</i> , <i>vaccinia virus</i>) antigen	10 ⁵ CFU/ml
8	Brucella	Device	1Tx10/Kit	Detection of <i>Brucella</i> spp. (<i>B.abortus</i> , <i>mellitensis</i> , <i>suis</i>) antigen	10 ⁵ CFU/ml
9	V. Cholerae O1 & O139	Device	1Tx10/Kit	Detection of <i>Vibrio cholerae</i> O1 & O139 LPS antigen No cross reactivity with other <i>Vibrio</i> spp.	10 ⁵ CFU/ml
10	Salmonella typhi	Device	1Tx10/Kit	Detection of <i>Salmonella typhi</i> antigen	10 ⁵ CFU/ml
11	Bio-Defense Pathogens & Toxins 9	Multi-Device	9Tx10/Kit	Simultaneous detection of the above 9 items	same as above
12	Bio-Defense Pathogens & Toxins 10	Multi-Device	10Tx10/Kit	Simultaneous detection of the above 10 items	same as above

Test Procedure

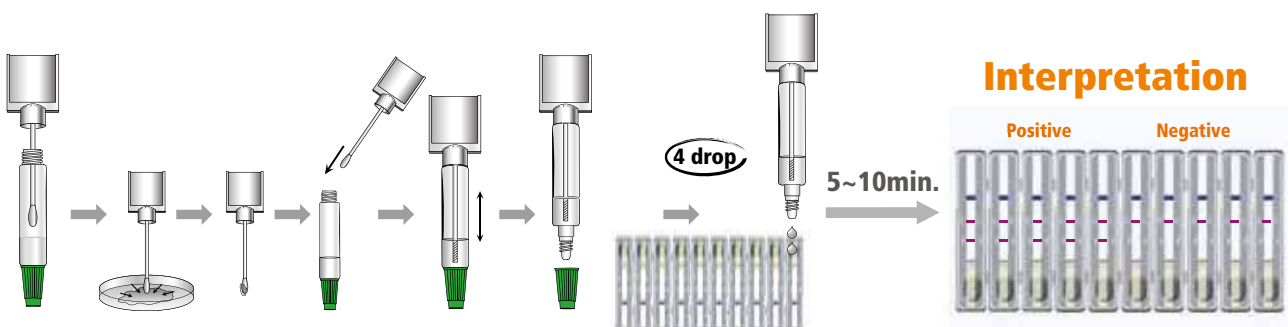

SD

BIO LINE

Blood Stain Inspection Semen Inspection



Forensic rapid test by one step immunochromatographic assay for the qualitative detection of Human Blood Stain and Human(male) Semen in environmental specimen.

General Information

Products	Characteristics
Blood Stain Inspection	<ul style="list-style-type: none"> • Diagnosing doubtful material as blood • Only detecting human blood (specific reactivity with human blood) • More accurate than conventional Luminol, LMG test by over 100 times • Detectable within 5~10 min. on the spot (helpful for early criminal investigation)
Semen Inspection	<ul style="list-style-type: none"> • Diagnosing doubtful material as semen • Specific reactivity with semen • More accurate than conventional SM test by over 100 times • Detectable within 5~10 min. on the spot (helpful for early criminal investigation)

Materials Provided

Blood Stain	Semen
<ul style="list-style-type: none"> • SD BIOLINE Blood Stain Test device • Assay diluent • Sample collection swab 	<ul style="list-style-type: none"> • SD BIOLINE Semen Test device • Assay diluent • Sample collection swab

Test Procedure

Blood Stain

Semen

5~10min.

4 drops

4 drops

Interpretation

Ordering Information

Cat. No.	Description	Type	Pack size
25FK21	Blood Stain Inspection	Device	1Tx5/Kit
22FK21	Semen Inspection	Device	1Tx5/Kit



SD UroColor™

Test for Blood, Bilirubin, Urobilinogen, Ketone, Protein, Nitrite, Glucose, pH, Specific gravity, Leucocytes and Ascorbic acid in urine.

General Information

- Clear positive and negative results
- Good resistance to humidity
- Checking an interference in Glucose, Blood, Bilirubin, Nitrite by Ascorbic acid ingested
- No color change after testing is completed
- No color spread between pH and specific gravity
- No interference in protein by alkali urine
- Long shelf life : 24 months
- Different color packages by parameters
- Fast result visually or instrumentally

Ordering Information

Cat No.	Product	Blood	Bilirubin	Urobilinogen	Ketone	Protein	Nitrite	Glucose	pH	Specific gravity	Leukocyte	Vitamin C
10UK01G	UroColor 1G							•				
10UK01P	UroColor 1P					•						
10UK01K	UroColor 1K				•							
10UK01B	UroColor 1Bi		•									
10UK01U	UroColor 1U			•								
10UK02	UroColor 2					•		•				
10UK02K	UroColor 2K				•			•				
10UK03	UroColor 3					•		•	•			
10UK03A	UroColor 3A	•				•		•				
10UK03K	UroColor 3K				•	•		•				
10UK03U	UroColor 3U			•		•		•				
10UK03N	UroColor 3N					•	•	•				
10UK04	UroColor 4	•				•		•	•			
10UK04K	UroColor 4K	•			•	•		•				
10UK04S	UroColor 4S					•		•	•	•		
10UK04P	UroColor 4K				•	•		•	•			
10UK05	UroColor 5	•		•		•		•	•			
10UK05B	UroColor 5Bi	•	•	•		•		•				
10UK05L	UroColor 5L	•				•	•	•			•	
10UK05K	UroColor 5K	•			•	•		•	•			
10UK05N	UroColor 5N	•				•	•	•	•			
10UK06	UroColor 6	•			•	•	•	•	•			
10UK06B	UroColor 6B	•	•		•	•		•	•			
10UK06U	UroColor 6U	•		•	•	•		•	•			
10UK06L	UroColor 6L	•			•	•	•	•	•		•	
10UK06NBi	UroColor 6NBi	•	•		•	•	•	•				
10UK07	UroColor 7	•	•	•	•	•		•	•			
10UK08	UroColor 8	•	•	•	•	•	•	•	•			
10UK08A	UroColor 8A	•	•	•	•	•	•	•				
10UK09	UroColor 9	•	•	•	•	•	•	•	•	•		
10UK09A	UroColor 9A	•	•	•	•	•	•	•	•			•
10UK10	UroColor 10	•	•	•	•	•	•	•	•	•	•	
10UK11	UroColor 11	•	•	•	•	•	•	•	•	•	•	•

UroColor Control

Cat. No.	Description	Type	Pack size
11UC11	UroColor Control Strip	Positive and Negative Strip	Positive 25T, Negative 25T